

ALLDAY
& MILLER



Central Avenue, Hayes, UB3 2BP
£500,000

 3  1  2  D



Central Avenue, Hayes, UB3 2BP

£500,000

- Three Bedrooms
- Semi-Detached House
- Chain Free
- Easy Reach To An Elizabeth Line Station
- Close To Lombardy Retail Park
- Corner Plot
- Great Potential To Extend STPP
- Blank Canvas
- Good Schools Nearby
- Garage

Description

Welcoming to the market this blank canvas semi-detached house situated on a corner plot. With great potential to extend(stpp) and no onward chain this property provides the perfect opportunity.

An excellent opportunity for those seeking a spacious family home with great potential. As you enter, you are welcomed by an entrance hall, an inviting reception with a fire place, downstairs WC & shower room, a fitted kitchen and a dining/second reception room completes the ground floor.

Ascending to the first floor, you will find three well-proportioned bedrooms, each offering a comfortable retreat.

To the rear is private garden mainly laid to lawn. Additionally, the outbuilding and garage provide valuable storage options or the potential for a workshop, enhancing the functionality of this property.

Situation

Central Avenue a perfectly located residential road in the heart of Hayes. The town centre just moments away with a variety of local cafes, coffee shops, Botwell leisure centre and supermarkets. Hayes and Harlington station 0.6 miles away with the Elizabeth line giving easy links to central London and back towards Heathrow and Reading. Also benefits from being close to multiple bus links connecting you to all local areas such as Uxbridge, Northolt, Greenford, Heathrow, Ealing and Harrow The M25, M4 motorways are just a short drive away. A number of highly regarded schools in the local area including Botwell House Catholic Primary School and Harlington secondary school.



Floor Plans

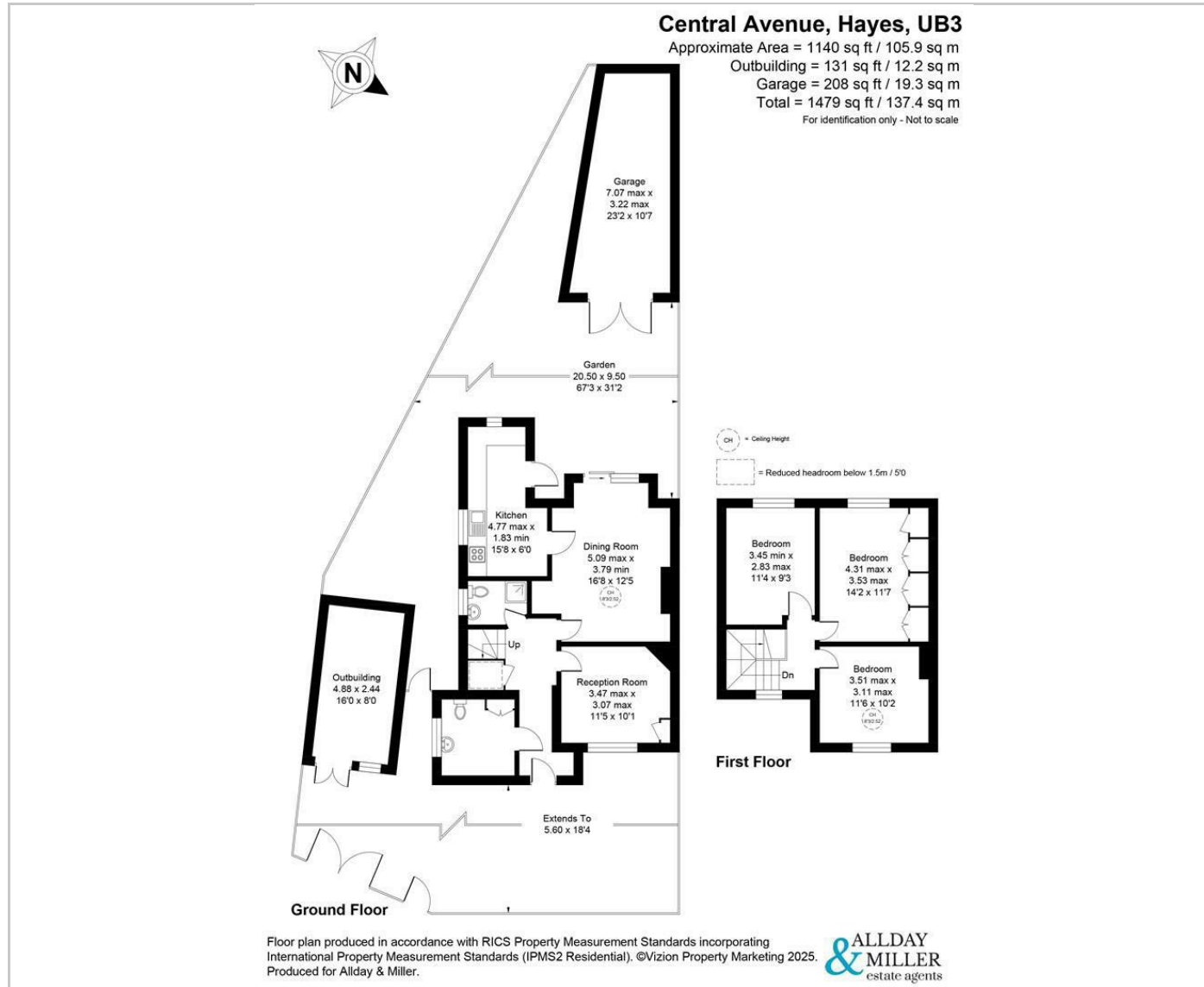

Area Map

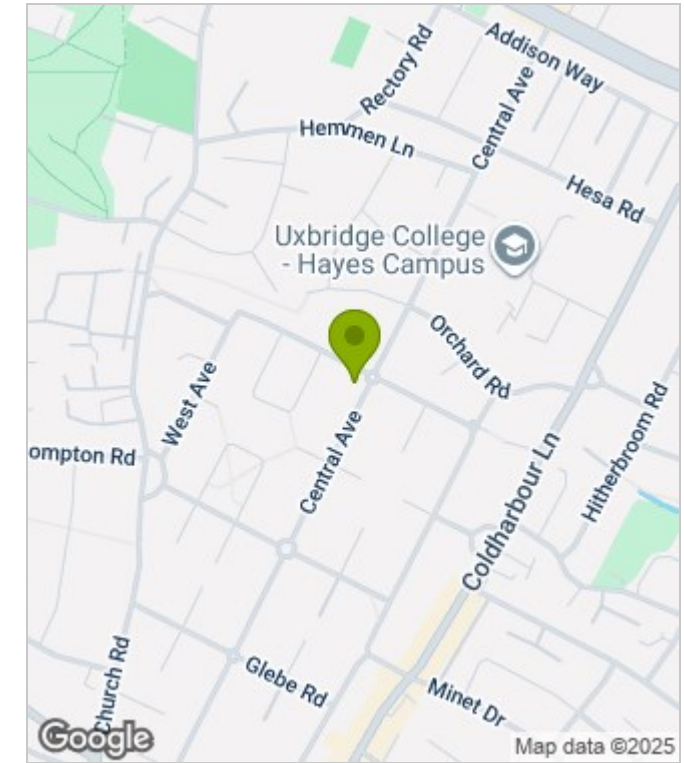

Energy Performance Graph

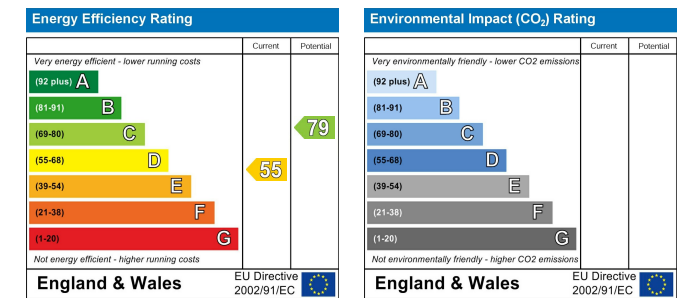

These particulars, whilst believed to be accurate are set out as a general outline only for guidance and do not constitute any part of an offer or contract. Intending purchasers should not rely on them as statements of representation of fact, but must satisfy themselves by inspection or otherwise as to their accuracy. No person in this firm's employment has the authority to make or give any representation or warranty in respect of the property.